



# User Manual

MiVue™ J30 Series

Revision: R01  
(1/2024)

## **Disclaimer**

The screenshots in this manual may differ between different operating systems and software versions. You can download the latest User Manual of your product from Mio™ website ([www.mio.com](http://www.mio.com)).

Specifications and documents are subject to change without notice. MiTAC does not warrant this document is error-free. MiTAC assumes no liability for damage incurred directly or indirectly from errors, omissions or discrepancies between the device and the documents.

## **Note**

Not all models are available in all regions.

Depending on the specific model purchased, the colour and look of your device and accessories may not exactly match the graphics shown in this document.

MiTAC Europe Ltd.

The Pinnacle, Station Way, Crawley RH10 1JH, UK

MiTAC Europe Ltd. Sp. Z o. o, Oddział w Polsce  
ul. Puławska 405 A, 02-801 Warszawa, Poland

# Table of Contents

Getting to know your dash cam.....	4
Power button .....	4
System indicator.....	5
MiVue Pro App.....	6
Setting up a WIFI connection .....	6
Updating your dash cam .....	7
Using your dash cam in a vehicle.....	8
Precautions and notices .....	8
Mounting the dash cam .....	9
Using a memory card .....	11
Formatting a card .....	11
Turning the dash cam on.....	12
Restarting the dash cam .....	12
Shutting down the dash cam .....	12
Recording in driving mode.....	13
Continuous recording .....	13
Event recording .....	13
System settings .....	14
Video Recording.....	14
System .....	14
MiVue Manager .....	15
Installing MiVue Manager.....	15
Playing the recording files .....	15

For more information .....	18
Caring for your device .....	18
Safety precautions.....	19
Regulatory information .....	19
UK Compliance Information .....	20
WEEE.....	20

# Getting to know your dash cam

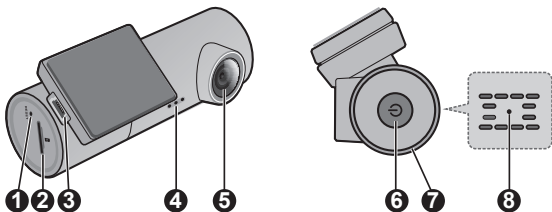

- ❶ RESET button
- ❷ Memory card slot
- ❸ Mini-USB connector
- ❹ Speaker
- ❺ Camera lens
- ❻ Power button
- ❼ System indicator
- ❽ Microphone

## Power button

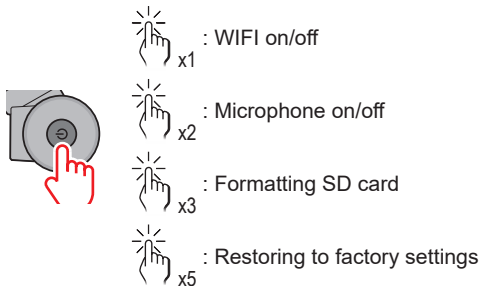

## System indicator

- Glows in **green** when the continuous recording is in progress.
- Flashes in **green** when the event recording is in progress.
- Glows in **amber** to indicate that the recording stops by some system issues (e.g. WIFI mode is turned on, an error with the memory card, etc.).
- Flashes in **amber** when an update is in progress.

# MiVue Pro App

The MiVue Pro app allows you to view, share and back up the videos recorded on a MiVue dash cam via WIFI. Search for "MiVue Pro" in Apple App Store or in Google Play Store to download the app for free.

## Note:

- The MiVue Pro app is compatible with iOS 9.0 (and above) and Android 5.0 (and above) devices. MiTAC does not guarantee the product's compatibility with smartphones from all manufacturers.
- Not all MiVue dash cam models support the MiVue Pro app or all its features.

## Setting up a WIFI connection

On the MiVue dash cam, press  briefly to enable the WIFI mode.

On your smartphone, follow the steps to set up the WIFI connection.

1. Make sure that you have enabled the WIFI function on the smartphone.
2. Open the MiVue Pro app and tap the "+" icon.
3. Tap **Select WIFI** and then select the dash cam you want to connect to.
4. Tap **Done** to complete the WIFI connection.
5. Once the devices are connected, the screen will display the main page (  ).

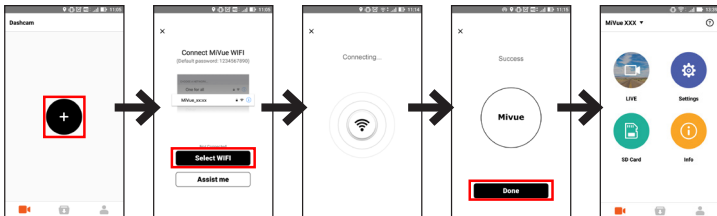

## Updating your dash cam

Occasionally, MiTAC may offer you various software updates (including the device firmware, safety camera data and audio data). You can upgrade the data via OTA updates of the MiVue Pro app. When the new data is available, you will be asked to upgrade the data when you open the app. Follow the on-screen instructions to complete the update.

# Using your dash cam in a vehicle

## Precautions and notices

- Do not operate the device while driving. Using this product does not change the requirement for a driver to take full responsibility for his or her behavior. This responsibility includes observing all traffic rules and regulations in order to avoid accidents, personal injury or property damage.
- A window mount is needed when using the dash cam in a car. Make sure that you place the dash cam in an appropriate place, so as not to obstruct the driver's view or deployment of airbags.
- Make sure that no object is blocking the camera lens and no reflective material is placed near the lens. Please keep the lens clean.
- If the car's windscreen is tinted with a coating, it may impact the recording quality.
- To ensure the highest quality recordings, you are advised to place the dash cam near the rear view mirror.
- Select an appropriate location for mounting the device in a vehicle. Never place the device where the driver's field of vision is blocked.
- The system will automatically calibrate the G sensor of the device during start-up. To avoid G sensor malfunction, always turn the device on AFTER you mount it in the vehicle properly.

## Mounting the dash cam

1. Make sure that your car is parked on level ground. Follow the instructions below to mount your dash cam in a vehicle securely.

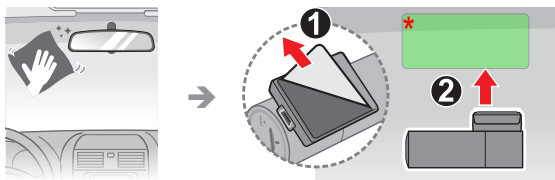

\* static cling film

### Note:

- Before sticking the mounting pad, clean the windscreen with rubbing alcohol.
- Attach the static cling film to the windscreen, and then install the mount over the static cling film.
- If the adhesion of the adhesive tape does not perform well, replace the tape with a new one.

2. Connect the car charger to the cigarette lighter. Route the cable through the top ceiling and the A-pillar so that it does not interfere with driving. Make sure that the cable installation does not interfere with the vehicle's airbags or other safety features.

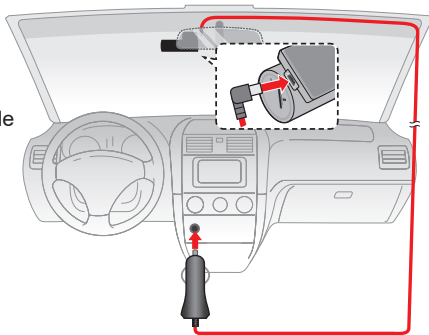

3. When adjusting the angle of mounting, make sure that the camera's view is parallel with the level ground and the ground/sky ratio is close to 50/50.

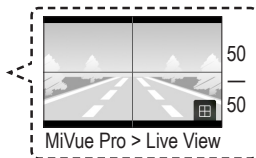
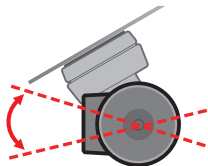

## Using a memory card

You must insert a memory card (not supplied) before you can start recording. The dash cam supports the Class 10 memory cards with 8 GB – 128 GB capacity. You should use separate MicroSD cards for recording and for regular data storage.

Hold the card (MicroSD) by the edges and gently insert it into the slot as shown in the illustration. To remove a card, gently push the top edge of the card inwards to release it and pull it out of the slot.

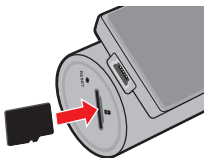

## Formatting a card

Use the MiVue Pro app to format a memory card (  > **Settings** > **Format SD Card** ).

### Note:

- DO NOT apply pressure to the centre of the memory card.
- MiTAC does not guarantee the product's compatibility with memory cards from all manufacturers.
- Before you start recording, please format the memory card to avoid malfunction caused by files not created by the dash cam.
- Turn the device off before removing the memory card.

## Turning the dash cam on

Complete the installation according to the instructions in the “Using your dash cam in a vehicle” section. The dash cam automatically turns on once it is connected to power source (e.g. the vehicle's cigarette charger with power supplied).

### Restarting the dash cam

Occasionally, you may need to perform a hardware reset when your Mio stops responding or if it appears to be “frozen” or unresponsive. To restart your Mio, insert a small rod (such as a straightened paperclip) into the RESET button of your Mio.

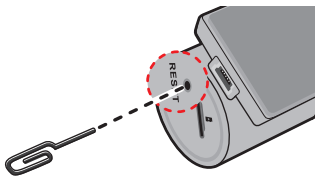

### Shutting down the dash cam

To shut down the dash cam, press and hold the Power button until the system is shut down.

# Recording in driving mode

## Continuous recording

By default, the system will automatically begin continuous recording in few seconds after start-up.

The recording may be divided into several video clips; recording will not stop between video clips.

## Event recording

By default, if an event happens such as a sudden impact, high speed driving, an aggressive turn or an accidental crash during continuous recording, the G sensor will prompt the dash cam to start recording the event.

**Note:** You can change the sensitivity level of the G sensor via the MiVue Pro app.

## System settings

Open the MiVue Pro app on the connected smartphone. Tap  > **Settings** to customise the system settings of the dash cam.

**Note:** Not all setting items and options are available for all models.

### Video Recording

- **Video Clip Length:** Sets the length of each video clip for a continuous recording.
- **Resolution:** Sets the resolution of the video.
- **Frequency:** Sets the frequency for the camera to avoid problems caused by artificial light sources that are not constant.
- **EV:** Sets the exposure level (-1 – +1) to adjust the brightness of the image.
- **G-Sensor:** Sets the sensitivity level of the G sensor that allows automatic triggering of event recording while continuous recording is in progress.
- **Record Sound:** Sets if you want to include sounds in the recordings.

### System

- **Welcome Sound:** Enables or disables the notification sounds during start-up.
- **Volume:** Adjusts the volume level.
- **Format SD Card:** Formats a memory card. (All data will be erased.)
- **Restore to Defaults:** Restores the system settings to the factory defaults.

# MiVue Manager

MiVue Manager™ is a tool for you to view the videos recorded on a MiVue dash cam.

**Note:** Not all features are available for every model.

## Installing MiVue Manager

Download MiVue Manager from the Support page of Mio website ([www.mio.com/support](http://www.mio.com/support)) and follow the on-screen prompts to install it. Make sure to download the correct software version (Windows or Mac) according to your computer's operating system.

## Playing the recording files

1. Remove the memory card from the dash cam and access the card on the computer via a card reader. You are advised to copy the recording files to your computer for backup and playback.
2. Start MiVue Manager on the computer.
  - By default, MiVue Manager shows the calendar and the file list on the right.
  - When a recording file exists, you will see the date marked with “•.” Click that date to display the files that were recorded on that date.
  - You can select the file type to display: **Event / Normal / Parking**.
  - To display all files in the current folder, click **All**. To return to the calendar view, click **Calendar**.
3. Double-click the desired file on the file list to start playback.
4. The playback controls are described as follows:



- 1 Skips to the previous / next file on the list.
  - 2 Starts or pauses the playback.
  - 3 Changes the playback speed to 1/4x, 1/2x, 1x (default), 1.5x, or 2x.
  - 4 Mutes or unmutes the volume.
  - 5 Adjusts the volume level.
  - 6 Plays the video in full screen.
  - 7 Displays the playback progress. You can click on a point along the track bar to move directly to a different location for the playback.
5. During playback, you can view more driving information from the dashboard panel and the G sensor chart that are displayed below the video playback screen.
- On the dashboard panel, click  to display the map screen.
  - The G sensor chart displays data in 3-axis waveform about the car's shift forward/backward (X), to the right/left (Y) and upward/downward (Z).

**Note:** The map screen may not display when the computer is not connected to the Internet or when your MiVue model does not support the GPS function.

6. The tool bar allows you to do the following:



- 1 Selects the folder that stores the recording files.
- 2 Previews and prints the current video image.
- 3 Saves the selected files to the specified location on your computer.
- 4 Captures and saves the current video image to the specified location on your computer.

- ⑤ Opens the Settings Menu.
  - **Change Language:** Sets the display language of MiVue Manager.
  - **Change Skin:** Sets the colour scheme of MiVue Manager.
  - **Check for Update:** Checks if there is any new version of MiVue Manager. (Internet access is required for this feature.)
  - **About:** Displays the version and copyright information of MiVue Manager.
- ⑥ Exports the GPS information of the selected file in the KML format to the specified location on your computer.
- ⑦ Uploads the selected file to YouTube™.

## For more information

### Caring for your device

Taking good care of your device will ensure trouble-free operation and reduce the risk of damage.

- Keep your device away from excessive moisture and extreme temperatures.
- Avoid exposing your device to direct sunlight or strong ultraviolet light for extended periods of time.
- Do not place anything on top of your device or drop objects on your device.
- Do not drop your device or subject it to severe shock.
- Do not subject your device to sudden and severe temperature changes. This could cause moisture condensation inside the unit, which could damage your device. In the event of moisture condensation, allow the device to dry out completely before use.
- Never clean your device with it powered on. Use a soft, lintfree cloth to wipe the exterior of your device.
- Never attempt to disassemble, repair or make any modifications to your device. Disassembling, modifying or any attempt to repair could cause damage to your device, may inflict bodily harm or damage to property and will void any warranty.
- Do not store or carry flammable liquids, gases or explosive materials in the same compartment as your device, its parts or accessories.
- To discourage theft do not leave the device and accessories in plain view in an unattended vehicle.
- Overheating may damage the device.

## Safety precautions

- Use only the charger supplied with your device. Use of another type of charger may result in malfunction and/or danger.
- This product is intended to be supplied by a LISTED Power Unit marked with “LPS”, “Limited Power Source” and output rated + 5V DC / 1.5A.
- Do not use the charger in a high moisture environment. Never touch the charger when your hands or feet are wet.
- Allow adequate ventilation around the charger when using it to operate the device or charge the battery. Do not cover the charger with paper or other objects that will reduce cooling. Do not use the charger while it is inside a carrying case.
- Connect the charger to a proper power source. The voltage requirements are found on the product case and/or packaging.
- Do not use the charger if the cord becomes damaged.
- Do not attempt to service the unit. There are no serviceable parts inside. Replace the unit if it is damaged or exposed to excess moisture.
- Operating temperature: -5°C – 65°C; Storage temperature: -20°C – 70°C
- IEEE 802.11 b/g/n 2.4GHz  
Operating frequency range: 2412–2472MHz  
Maximum output power: 16±2dBm

## Regulatory information

For regulatory identification purposes, MiVue J30 Series is assigned a model number of N718.



Products with the CE marking comply with the Radio Equipment Directive (RED) (2014/53/EU) - issued by the Commission of the European Community.

Compliance with these directives implies conformity to the following European Standards:

EN 50665:2017 / EN IEC 62311:2020

EN IEC 62368-1:2020+A11:2020

ETSI EN 301 489-1 V2.2.3 (2019-11)

ETSI EN 301 489-17 V3.2.4 (2020-09)

ETSI EN 301 489-19 V2.1.1 (2019-04)

EN 55032: 2015+A11: 2020+A1 :2020

EN 55035: 2017+A11: 2020

EN IEC 61000-3-2: 2019+A1: 2021

EN 61000-3-3: 2013+A1: 2019+A2: 2021

ETSI EN 300 328 V2.2.2 (2019-07)

ETSI EN 303 413 V1.2.1 (2021-04)

The manufacturer cannot be held responsible for modifications made by the User and the consequences thereof, which may alter the conformity of the product with the CE Marking.

### **Declaration of conformity**

Hereby, MiTAC declares that this N718 is in compliance with the essential requirements and other relevant provisions of Directive 2014/53/EU.

### **UK Compliance Information**



Hereby, MiTAC declares that this device is in compliance with Radio Equipment Regulations 2017.

### **WEEE**



This product must not be disposed of as normal household waste, in accordance with the EU directive for waste electrical and electronic equipment (WEEE – 2012/19/EU). Instead, it should be disposed of by returning it to the point of sale, or to a municipal recycling collection point.